

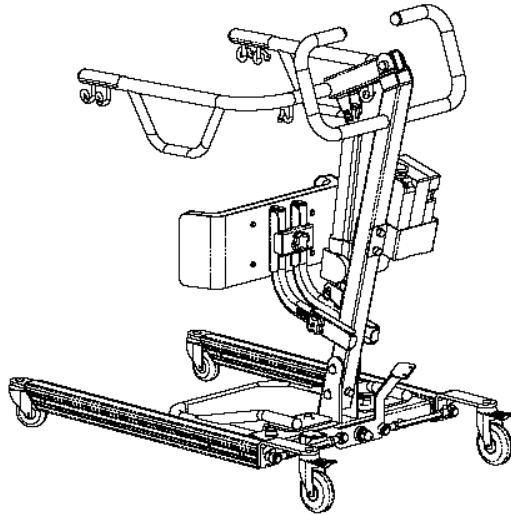

BestcareLift Stella

OWNER'S MANUAL



SAL1230 (Standard Stella)

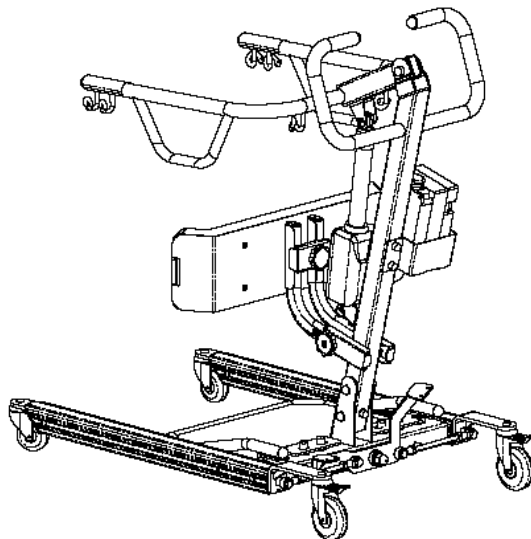

SAL1260HD (Bariatric Stella)

Thank you for choosing the Bestcare Stella Lift

IMPORTANT NOTES

Please pay attention to the important information regarding the care, maintenance, and operation of the Bestcare Stella Lift in this manual.

Please read the instructions carefully before assembling the lift, or attempting to lift any patient with the device.

Always keep the Owner's Manual available with the lift.

Remember to complete the warranty registration card and mail it back.

Maximum Load Capacity:

1. Standard Stella Model #SAL1230 – 400lbs
2. Bariatric Stella Model #SAL1260HD – 600lbs

Bestcare LLC.

*5885 Shiloh Road, Suite 104
Alpharetta, GA 30005 U. S. A.*

Toll free : 1-877-822-9033

Tel : 678-679-6690

Fax : 678-679-6697

Web Site: www.bestcarellc.com

Copyright ©2011

SAFETY PRECAUTIONS

The Bestcare Stella Lift stand assist lift allows a caregiver to lift and transfer a patient safely with minimum physical effort. Before attempting to lift anyone, one should practice operating the lift and explain to the patient the lifting procedures.

Arrange all necessary items (e.g. lift, sling, commode chair or wheelchair) properly for a smooth procedure.

- Special care must be taken with patients who cannot provide assistance while being lifted. (i.e. patients who are comatose, spastic, agitated or otherwise severely handicapped).
- The Bestcare Stella Lift should be used solely for transferring a patient from one object (beds, bathtubs, toilets, etc.) to another.

The lift should not be used for transporting or moving any patient from one location to another location.

- During lifting or lowering, whenever possible, always keep lift base widened.
- Always keep the patient being lifted centered over the base and facing the caregiver operating the lifter.
- Do not roll casters over any object while the user is in the sling.
- Use only BestcareLift slings specially designed for Bestcare Stella Lift. Do not use slings manufactured by other company on Bestcare Stella Lift. Bestcare LLC. is not responsible for any consequence resulting from using non-BestcareLift products.
- Do not put anything (e.g. cushion, pad, etc.....) between the user and the sling. This may cause user to slide out of the sling and cause injury.
- Use only BestcareLift parts or components. Bestcare LLC. is not responsible for any consequence resulting from using non-BestcareLift parts and components.
- Service and repair of the Bestcare Stella Lift should be performed by Bestcare LLC. or its authorized dealer. Bestcare LLC. is not responsible for any consequence resulting from any unauthorized service or repair.
- Do not lift over the maximum weight allowed.

Warning!

Do not attempt to transfer a patient without prior approval of the person's nurse. Also, do not transfer without having studied the instructions and performed several practices in operating the product. Together (with the patient's doctor, nurse, or medical attendant) select a sling that is both practical and comfortable. The sling selected should be one that serves the needs of the patient, while providing the patient with optimal safety. Never interfere with the lift, unless instructed by the attendant. Have a doctor, nurse, or medical attendant (experienced in the use of the Bestcare Stella Lift) present during the first few times the lift is used to transfer a new user.

FEATURES

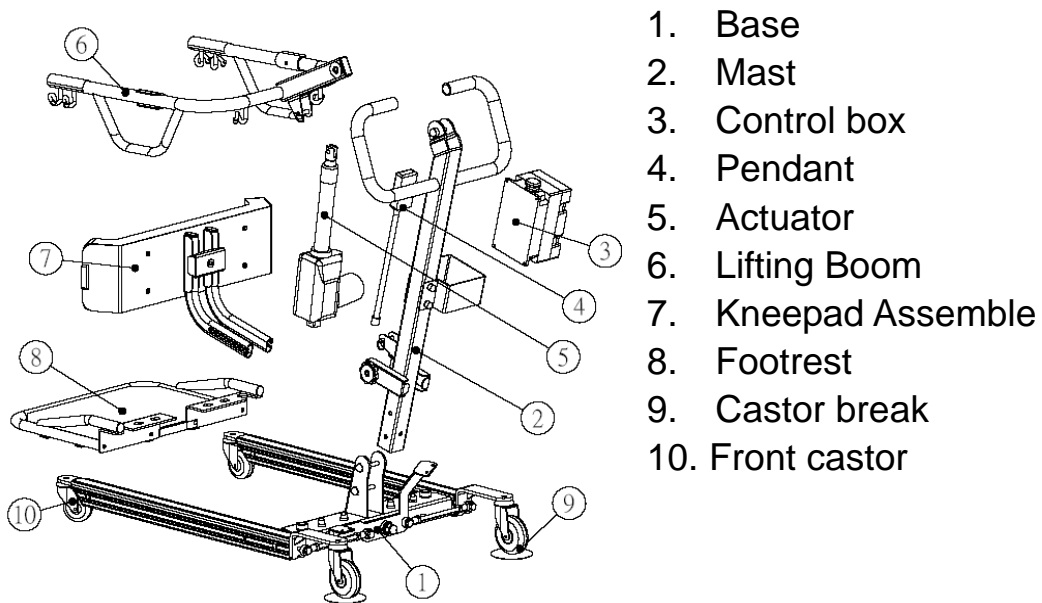
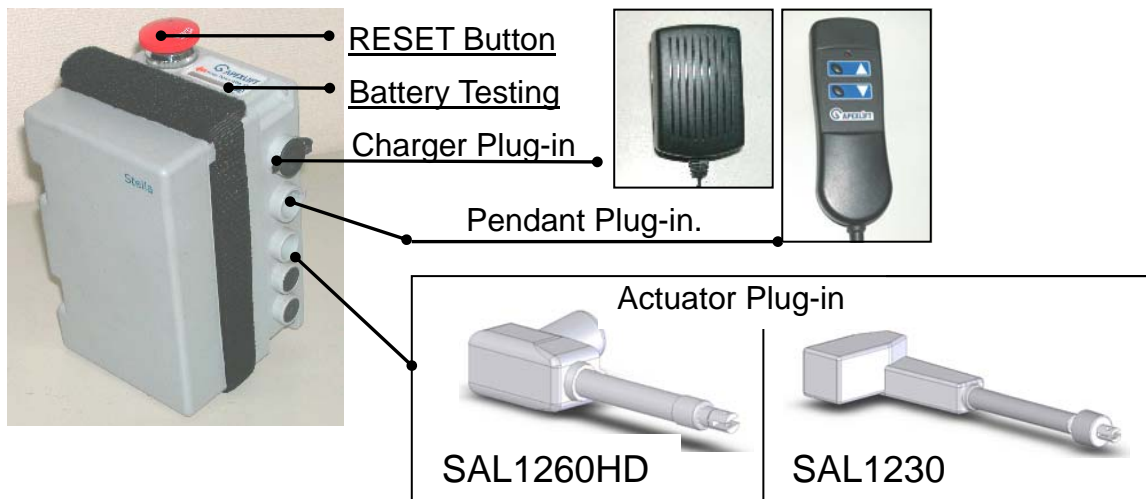
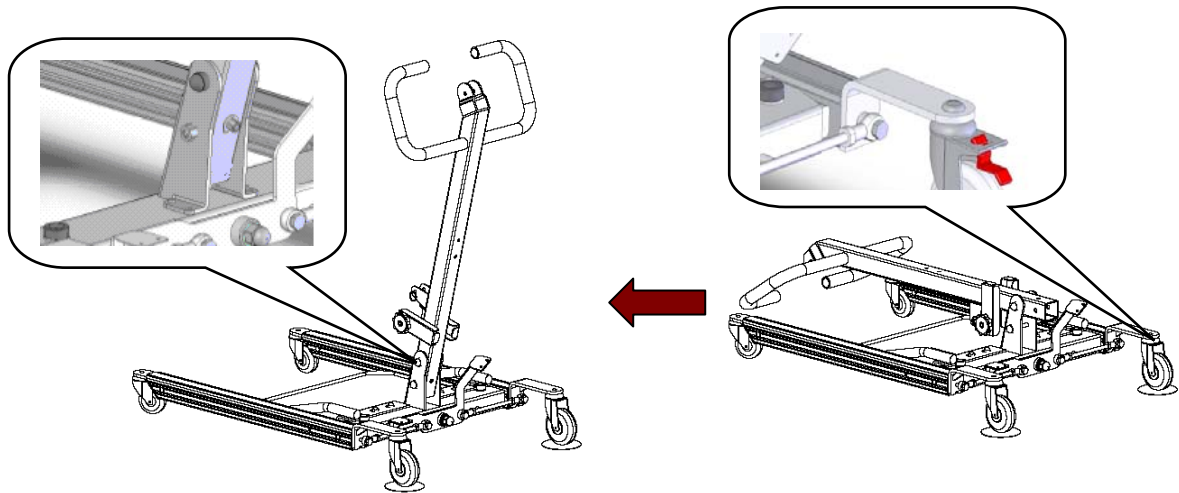

Diagram of control box



ASSEMBLY INSTRUCTIONS

1. Open the box and take lift out.
2. Engage the brakes. Remove the bolts from the bottom of the mast and base. Pull the Mast to an upright position. Re-insert the bolts into the holes at bottom of the mast and tighten the nuts.



3. Attach boom to top of mast. Re-insert the bolts into the holes at bottom of the mast and tighten the nuts.

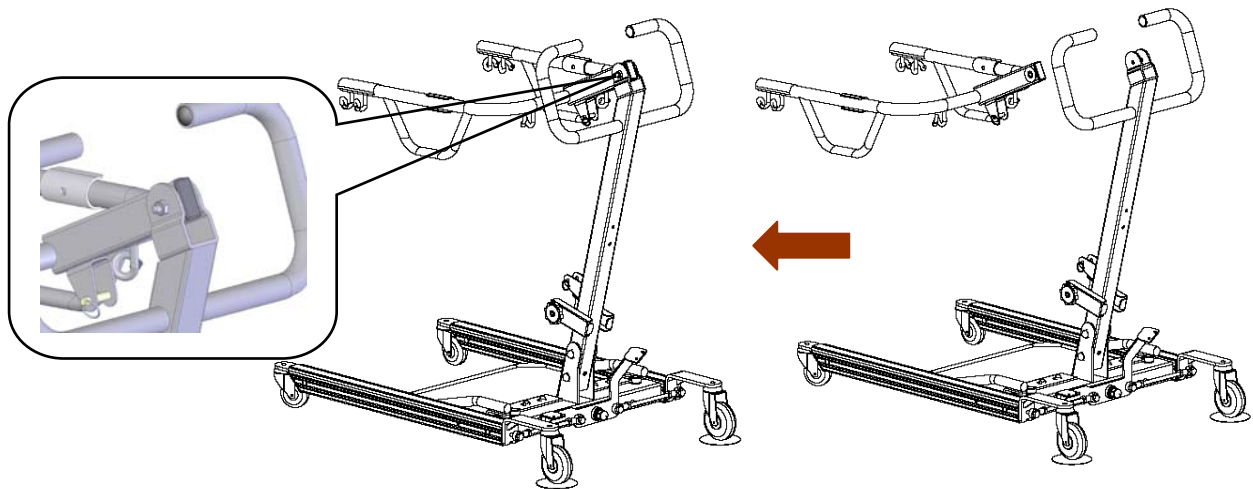

4. Follow the following instructions to install the Actuator.
 - a. Attach the bottom of Actuator to the bracket on the Mast and insert pin. Insert keeper ring through hole in pin to secure base of actuator.
 - b. Attach the top of the Actuator to the bracket on the Boom and insert pin. Insert keeper ring through hole in pin to secure actuator to upper bracket.

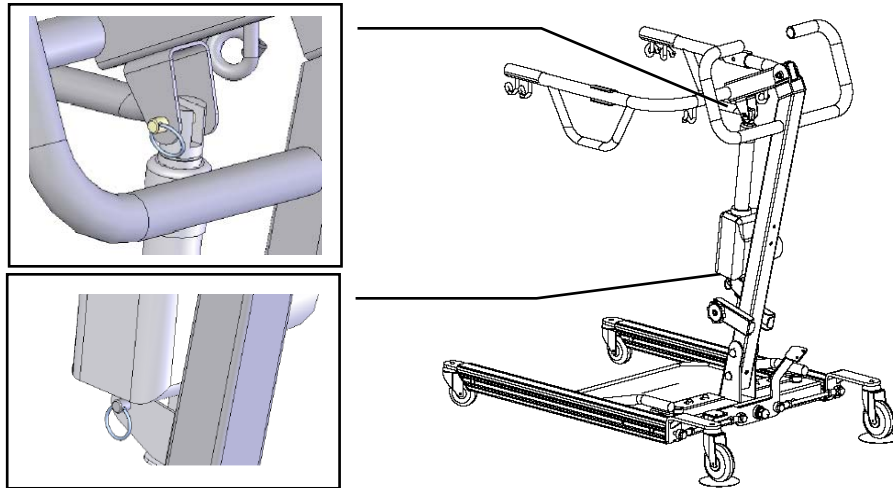

5. Attach the Control Box Hanging Bracket to the Mast and tighten the nuts.
6. Place the control box inside the bracket.

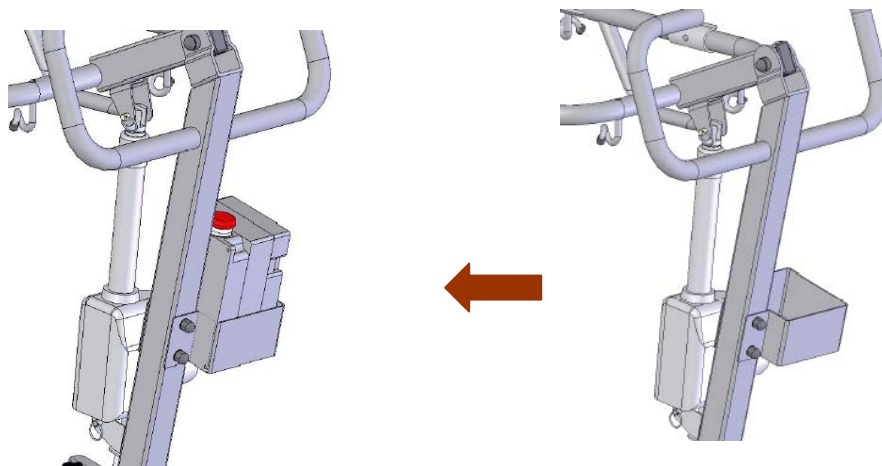

7. Attach the L-shaped arms to back of the kneepad. For desired height of the kneepad, use proper holes on the L-shaped arms.

STEP 1:

Attach the L-shaped arms to the mast.
Make adjustment to the desired position.

STEP 2:

Use the bolt to fasten the L-shaped arms to the Mast.

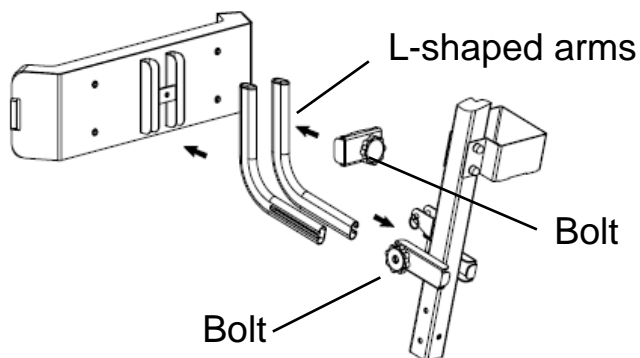

8. Attach kneepad assembly to the mast.

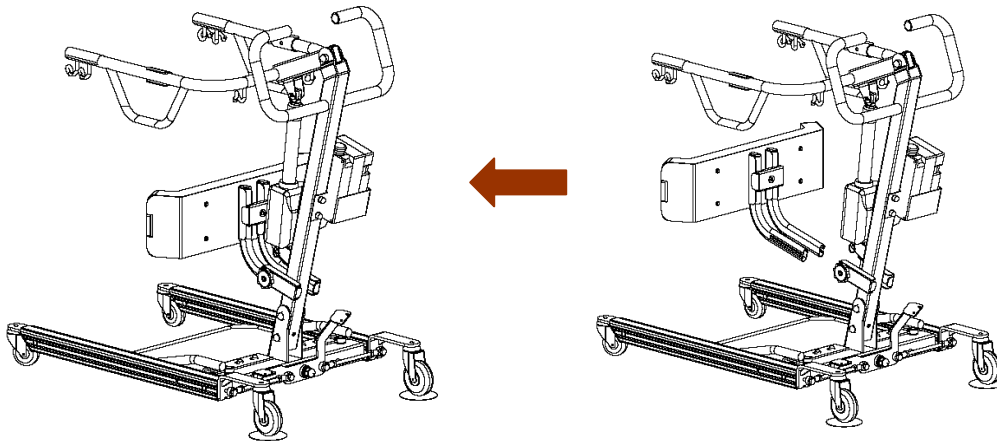

9. Attach actuator and pendant to the control box.

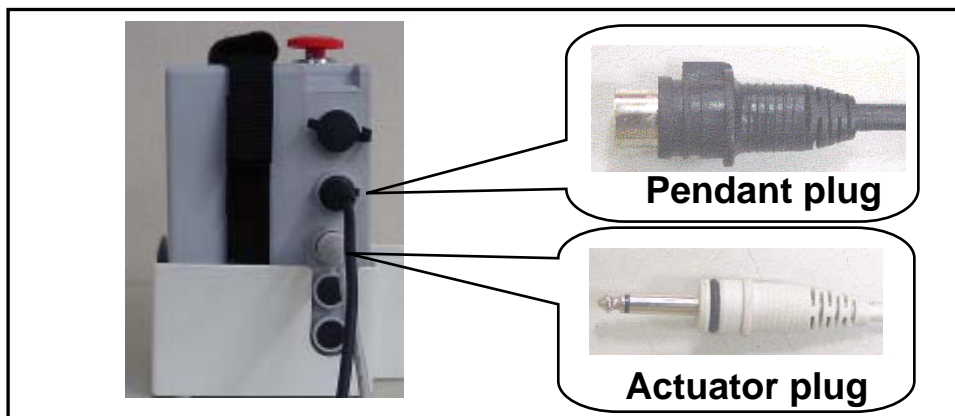

10. Tighten all nuts.
11. Make sure the lift is sturdy before use .

NOTE:

Prior to using the Bestcare Stella Lift, charge the batteries for 10-12 hours.

OPERATION INSTRUCTIONS

Preparation Before Lifting

1. Turn on the power by twisting the RED RESET BUTTON clockwise.
2. Press the UP or DOWN button on the hand control once. Check if the battery indicator lights are on. To proceed with lifting, make sure there is at least one green light. Batteries are fully charged when three (3) green lights are shown.
3. After the battery indicator lights went out, push the UP button and the DOWN button on the hand control and ensure that the lift is operating correctly.
4. Position of the base of lift around or under the object.
5. Widen the base and engage the caster brakes.

Fitting BestcareLift Stand Assist Sling

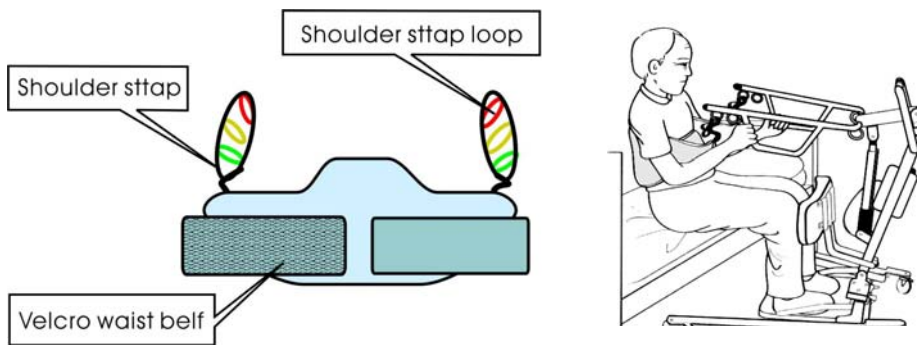

Safety Note: The BestcareStella Lift stand assist sling is not suitable for patients who have involuntary movements, or patients with limited postural control.

Position the patient in a sitting position.

1. Slide the sling down patient's back to lumbar position.
2. Draw the shoulder straps to the front of the patient close to the chest.
3. Draw the waist belt around patient's waist and press together to fasten.
4. Attach the shoulder straps to the hooks.

Sling application the steps should be as follows:

1. Place sling behind seated patient with the 2 red pads under the arms.
2. Cross the adjustable chest belt over and fasten it securely using the buckle.(adjust for comfort)
3. Cross the short black strap over and pull the left loop strap through the black strap.
4. Hook the two loop straps to the hooks on the lift boom using the same hook and loop sequence on each side.
5. The black strap will be straight across in front of patient to stabilize the sling during lift.
6. Have patient grasp handles on boom and tilt head back slightly.
7. Make sure the patients feet are firmly on the platform and knees are touching the kneepads with kneecaps just above the padding.
8. Use the lift to complete the lift and pivot transfer.

Lift and Transfer From Bed

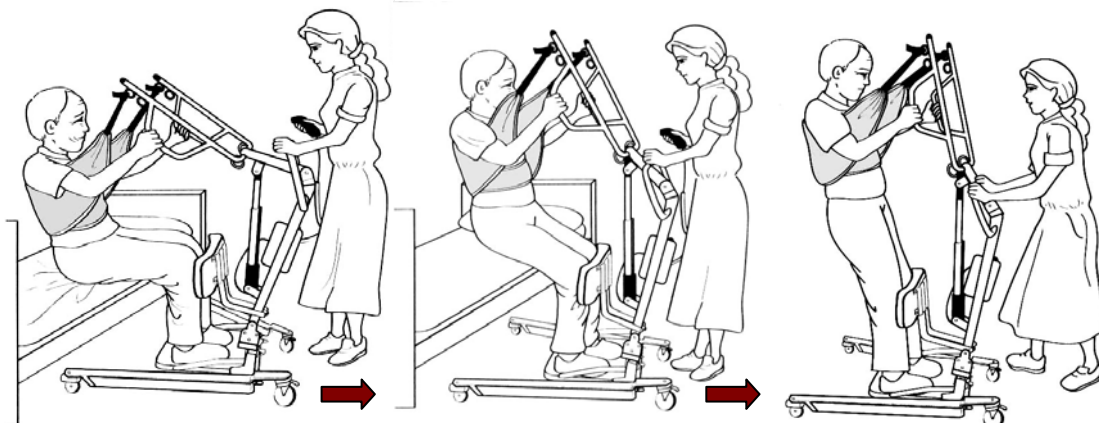

1. Fit sling as described in “Fitting Bestcare Stella Lift Stand Assist Sling”.
2. Push lift towards patient. Open the base of the lift. Apply the brakes in both rear casters.
3. Position patient’s feet on the foot platform and knees against the knee pad.
4. Attached the sling straps to the hooks.
5. Have the patient’s hands holding the handles. For patient’s who cannot hold the handles, have them hold their arms around the chest.
6. Press the “UP” button on the hand control.
7. Before the patient’s body has lifted from the bed, stop and make sure the sling is secured and patient’s knees are against the knee pad.
8. The patient should be comfortable with the pressure under the arms. If not, adjust the sling and try another loop option to release pressure.

9. Press the “UP” button until the patient’s body is completely left the bed.
10. Transfer to another object can be done at this position without the patient attending a full standing position.
11. Release the brakes, close the base, and pull the lift away from the bed.
12. Lower the patient to the object intended.
13. To lift patient in a standing position, continue to lift until the patient’s knees are locked in a standing position.
14. At the standing position, patient’s knees may move away from the knee pad.
15. Release the brakes, close the base, and pull the lift away from the bed.
16. Lower the patient to the object intended.
17. Reverse the above procedures when lowering the patient to the bed.

Lift and Transfer From Wheelchair

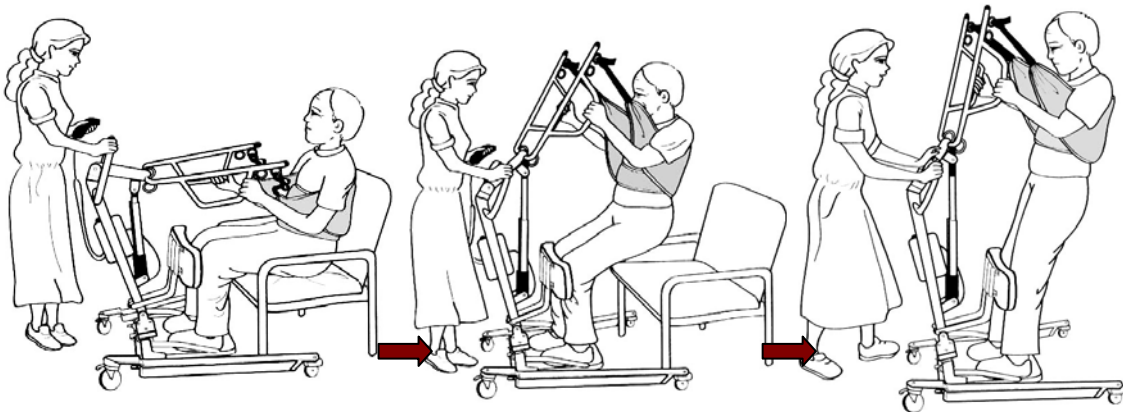

1. Fit sling as described in “Fitting Bestcare Stand Lift Assist Sling”.
2. Push lift towards patient. Open the base of the lift to go around the chair. Apply the brakes in both rear casters.
3. Position patient’s feet on the foot platform and knees against the knee pad.
4. Attached the sling straps to the hooks.
5. Have the patient’s hands holding the handles. For patients who cannot hold the handles, have them hold their arms around the chest.
6. Press the “UP” button on the hand control.
7. Before the patient’s body is lifted from the chair, stop and make sure the sling is secured and patient’s knees are against the knee pad.

The patient should be comfortable with the pressure under the arms. If not, adjust the sling and try another loop option to release pressure.

8. Press the "UP" button until the patient's body has completely left the chair.
9. Transfer to another object can be done at this position without the patient attending a full standing position.
10. Release the brakes, close the base, and pull the lift away from the bed.
11. Lower the patient to the object intended.
12. To lift patient in a standing position, continue to lift until the patient's knees are locked in a standing position.
13. At the standing position, patient's knees may move away from the knee pad.
14. Release the brakes, close the base, and pull the lift away from the bed.
15. Lower the patient to the object intended.
16. Reverse the above procedures when lowering the patient to the bed.

Checking The Battery

1. Check batteries by pressing the Battery Testing Button (blue circle with a battery sign) on the control box.
2. Batteries are fully charged when all lights on the Battery Indicator are "ON".
3. Charge batteries when Indicator shown only one "GREEN" light.
4. Do not use the lift when no "GREEN" light is shown. Charge the batteries immediately.
5. Replace batteries when frequent charging is needed.

Know What The Battery Indicator Lights Are Telling You:

RED	AMBER	GREEN	GREEN	GREEN	
ON	ON	ON	ON	ON	FULLY CHARGED
ON	ON	ON	OFF	OFF	NEED CHARGE
ON	ON / OFF	OFF	OFF	OFF	CHARGE IMMEDIATELY. DON'T USE THE LIFT
OFF	OFF	OFF	OFF	OFF	BAD BATTERIES OR BAD CONNECTION

Warning Buzzers

The control box has a buzzer that provides you with information on the status of the batteries and the lift. To stop the buzzer, push down the RESET button or press the Battery Indicator.

BUZZER TYPE	INDICATION	NOTE
2 beeps/sec	Low Battery (red/amber lights on)	Charge batteries immediately.
3 beeps/sec	Low Battery (red light on)	Charge batteries immediately.
6 beeps/sec	Very Low Battery (no light on)	Charge batteries immediately.
3 beeps every other second	Bad Battery (no light on)	Replace batteries.
3 long beeps	Overloaded. Batteries are charged but lift does not lift.	Exceeded maximum load capacity.

Charging The Batteries

1. Ensure the power is switched "ON" (the red "RESET" button should be up).
2. Insert charging plug into charging port on the control box.
3. Plug charger to power supply.
4. All lights of battery indicator should be "ON" while charging.
5. It takes approximately 2-3 hours to fully charge the batteries from one green light.
6. It takes approximately 7-9 hours to fully charge the batteries from the red light.
7. Do not leave the batteries on charging for an extensive period of time. This will shorten the life of the batteries.
8. Do not let the batteries run down to the last red light. This might shorten the life of the batteries or damage the batteries.
9. Unplug the charger first before using the lift.

THE BESTCARE STELLA WILL NOT OPERATE WHILE CHARGING.

Important Notes On Charging

- Push lift to charging location and charge the batteries with the charger provided. Avoid unplug hand control and motor from control box. Frequent plug/unplug of the hand control and motor into/from the control box may damage the control box.
- Do not charge batteries over 12 hours.

MAINTENANCE AND INSPECTION INSTRUCTIONS

- The operator of the lift shall inspect the Bestcare Stella Lift before each use. Check all bolts for tightness. Make sure the base can be easily widened, and that all lift parts are in place. Make sure that casters can be turned freely, and that caster brakes can be engaged. Make certain all necessary items (i.e. slings, and wheelchairs, etc.) are ready for use.
- At least once a month, the lift should be thoroughly inspected by a person qualified to recognize any signs of wear and tear, and looseness of bolts or parts. Replace any worn parts immediately.
- To lubricate, put a drop of oil on the following points when the Bestcare Stella Lift is placed into service and every month thereafter. Top of Mast, Spreader Hinge, and Caster Axles.

Table of Maintenance Schedule:

Item	In the Beginning	Monthly	Every 3 month
1. Boom & Spreader Bar : <ul style="list-style-type: none"> • Check connections between 1) Boom and Spreader Bar 2) Boom and Mast for improper connection, looseness, or wear. • Check the Boom for bending and deflection. 	• •	• •	
2. The Mast : <ul style="list-style-type: none"> • Check Mast for bending or deflection. 	•	•	
3. The Base & Foot Paddle : <ul style="list-style-type: none"> • Check bolts and nuts for looseness. • Check casters and bolts for tightness. • Check rubber parts of the casters for deflection. • Apply grease to caster ball bearings if needed. • Check welding joints for rust and crack. 	• •	• • •	• •
4. Cleaning : <ul style="list-style-type: none"> • Any time needed. 			•
5. Actuator & Control Box: <ul style="list-style-type: none"> • Make sure the control box is firmly affixed to the mast. • Make sure the pins are firmly affixed the actuator to the Boom and the Mast. • Make sure the connecting cable of actuator and control box is not loose. • Make sure that the Battery Indicator shows at least 2 green LED prior to use. 	• • • •	• • • •	
6. Slings & Sling Hardware: <ul style="list-style-type: none"> • Check sling for wear. • Check sling hardware before use. 	• •	• •	

Troubleshooting Guide

The following list of encountered problems and solutions will assist you in determining what may be causing your Bestcare lift not to function as designed. If you have a problem occurring which is not listed below please contact your dealer or Bestcare technical support for help. Do not attempt to repair components or parts on your lift as this may invalidate your warranty or cause further problems that may result in patient injury. Stop using your lift immediately if it is not functioning correctly or any warning beeps are heard.

I need to re-charge my batteries often or they fail to hold a charge when I charge them

- Replace the 2 internal batteries as they are at the end of their life cycle
- Batteries should be changed every 18-24 months depending on usage

When I plug my charger into the control box I see no lights on the battery indicator

- Check to make sure the red re-set button is in the up position
- Check to make sure the charger is firmly in the control box and plugged into a wall socket
- Replace your charger as it is at the end of its life cycle
- If your charger is transmitting current then you need to replace your PCB board in the control box

My actuator makes a clicking sound when I attempt to use my lift

- Check to make sure the actuator plug is pushed into the control box so the O Ring is not visible
- Your actuator needs to be replaced as it is at the end of its life cycle
- Your PCB board in the control box may be malfunctioning

The actuator will either go up or down but not both

- Replace your hand control as it is at the end of its life cycle
- Your PCB board in the control box may be malfunctioning

There is a grinding sound inside the actuator when lifting

- Replace your actuator as the internal gears are stripped

The actuator stops and starts while lifting or lowering

- Replace your batteries as they are at the end of their life cycle

My lift will not operate even though it shows the batteries are charged

- Disconnect your charger from the control box as the lift will not work when the charger is attached
- Check to make sure the hand control is properly inserted to control box
- Check to make sure your actuator is properly connected to the control box
- Your hand control needs to be replaced as it is at the end of its life cycle

My lift will not operate and battery indicator has no lights illuminated

- Check to make sure the red re-set button is in the up position
- The internal batteries may not be connected together properly with the connection wires
- Batteries will no longer hold a charge and must be replaced
- Your PCB board is damaged and must be replaced

When lifting I hear 3 long beeps from the control box

- You are attempting to lift someone heavier than the safe working load
- Stop the lift and lower safely to bed or chair immediately

When lifting I hear short beeping sounds from the control box

- Charge the batteries
- Replace the batteries if they fail to hold a charge

If there is any problem you could not solve, please contact the dealer for assistance.

ACCESSORIES

BestcareLift Toileting Sling

The BestcareLift Toileting Sling can be used with the BestcareLiftStella to lift a patient in a sitting position. When in use the BestcareLift Toileting Sling supports the client under the thighs and across the mid-back area.

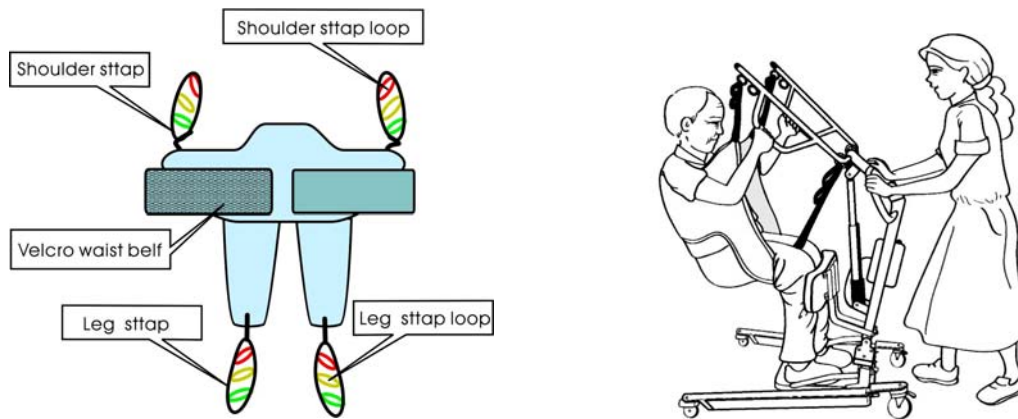

Safety Note:

The BestcareLift Toileting Sling is not suitable for patients who have involuntary movements, or patients with limited postural control.

Fitting The BestcareLift Toileting Sling

1. Slide the sling down patients back to lumbar position.
2. Draw shoulder straps under the arms and around the chest into the front.
3. Draw Velcro waist belt around waist and press together to fasten.
4. Draw each leg support under the thigh.
5. Crisscross leg straps by feeding one of the leg straps through the other strap.
6. Attach shoulder straps to hooks in upper ends of the lifting arms.
7. Attach leg straps to hooks in the lower ends of the lifting arms.



BESTCARE LLC
WARRANTY POLICY 2011
Effective March 7th 2011

Bestcare LLC offers a limited warranty on all patient lifts, slings and accessories to be free of defects in workmanship and product performance. This warranty is extended only to the original purchaser/user and is therefore non transferrable. Any warranty claims must be submitted through an authorized dealer or distributor that sold the original product with proper proof of sale and serial number supplied. Prior authorization from Bestcare LLC is required for any warranty replacement and we reserve the right to replace parts and or accessories in lieu of sending complete new patient lifts. Dealers and distributors will be billed for any advance warranty replacement items shipped and credited at 100% only when the defective items have been returned to Bestcare LLC and proven defective. Product returned without a Bestcare LLC return authorization will be refused. Returns received 30 days after the issuance of a return authorization will also be refused as the authorization will have expired. The final disposition of warranty claims will be subject to our inspection of the returned items. Bestcare LLC has the right to determine valid claims based on the individual circumstances of each claim. Warranty claims will be denied should evidence of the following be determined:

- Misuse of product , modification of product or failure to maintain as per the owner's manual
- Serial number removed or defaced
- Normal wear and tear

Bestcare LLC warrants the following products and components for the time period specified:

- Lift frames and spreader bar: 3 years
- Actuator: 2 years
- Parts including casters, control box, PCB, pendant, charger: 2 years
- Batteries: 1 year
- Weigh Scale: 2 years
- Spryte stand aid all components: 2 years
- Hydraulic pumps: 1 year
- Reusable slings: 6 months

Bestcare LLC Single Patient Slings are designed for limited use with one patient and may not be washed. Bestcare will replace any disposable slings found to have a manufacturing defect. Normal wear and tear will not be covered under warranty.

Thank you for choosing the Bestcare Stella Lift

Bestcare LLC.

*5885 Shiloh Road, Suite 104
Alpharetta, GA 30005 U. S. A.
Toll free : 1-877-822-9033
Tel : 678-679-6690
Fax : 678-679-6697*

Web Site: www.bestcarellc.com